

# Retail Space FOR LEASE



## 6380 RICHMOND ROAD, SUITE B

Williamsburg, VA

- Excellent Retail Opportunity
- Situated on the southwest corner of the signalized intersection of Centerville Road and Richmond Road in the 13,600 SF Lightfoot Specialty Shops which is anchored by United States Post Office.
- Immediately accessible to both US Route 199 and Interstate 64.
- Lightfoot Specialty Shops are located just west of the US Route 199 & Richmond Road intersection in Williamsburg's newest retail HUB, Lightfoot. Super Wal-mart, Lowe's, Williamsburg Ford, Sentara Hospital, Thomas Nelson Community College Williamsburg Campus, Williamsburg/James City County Warhill High School and the Great Wolf Lodge are all located in the Lightfoot area of Williamsburg.

### SIZE:

3,300 SF

### LEASE RATE:

\$16.00/ SF

### CAM CHARGES:

\$2.50/ SF

### TRAFFIC COUNT:

19,000 per day

## RJS & Associates. Inc.

Commercial Real Estate  
Brokerage

423 N. Boundary Street, Ste 200  
Williamsburg, Virginia 23185-5629



For more Information  
*Contact:*

Robert J. Singley, Jr. *CCIM*

**(757) 229-3139**

**Fax (757) 220-2475**

**rjsjr@rjsassoc.com**

**6380 RICHMOND RD, SUITE B • WILLIAMSBURG, VA**

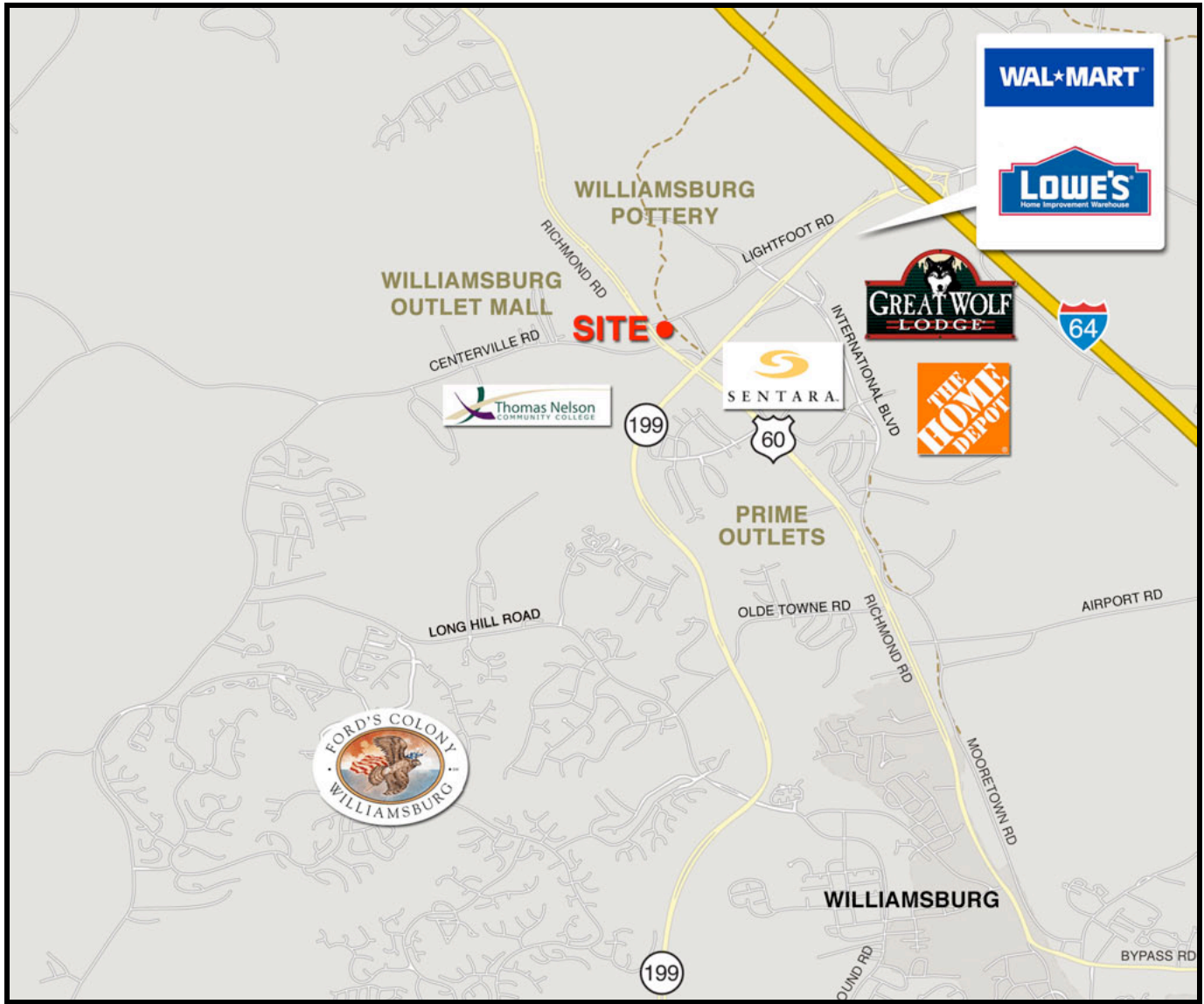

**MAP**

**2010 Demographics:**

	<b>3 Mile</b>	<b>5 Mile</b>	<b>7 Mile</b>
Population:	18,741	37,644	69,927
Households:	7,558	15,216	26,946
Median Household Income:	\$65,302	\$64,478	\$66,702

**RJS & Associates. Inc.**

Commercial Real Estate  
Brokerage

423 N. Boundary Street, Ste 200  
Williamsburg, Virginia 23185-5629



**For more Information  
Contact:**

Robert J. Singley, Jr. *CCIM*  
**(757) 229-3139**  
Fax (757) 220-2475  
rjsjr@rjsassoc.com

**6380 RICHMOND RD, SUITE B • WILLIAMSBURG, VA**

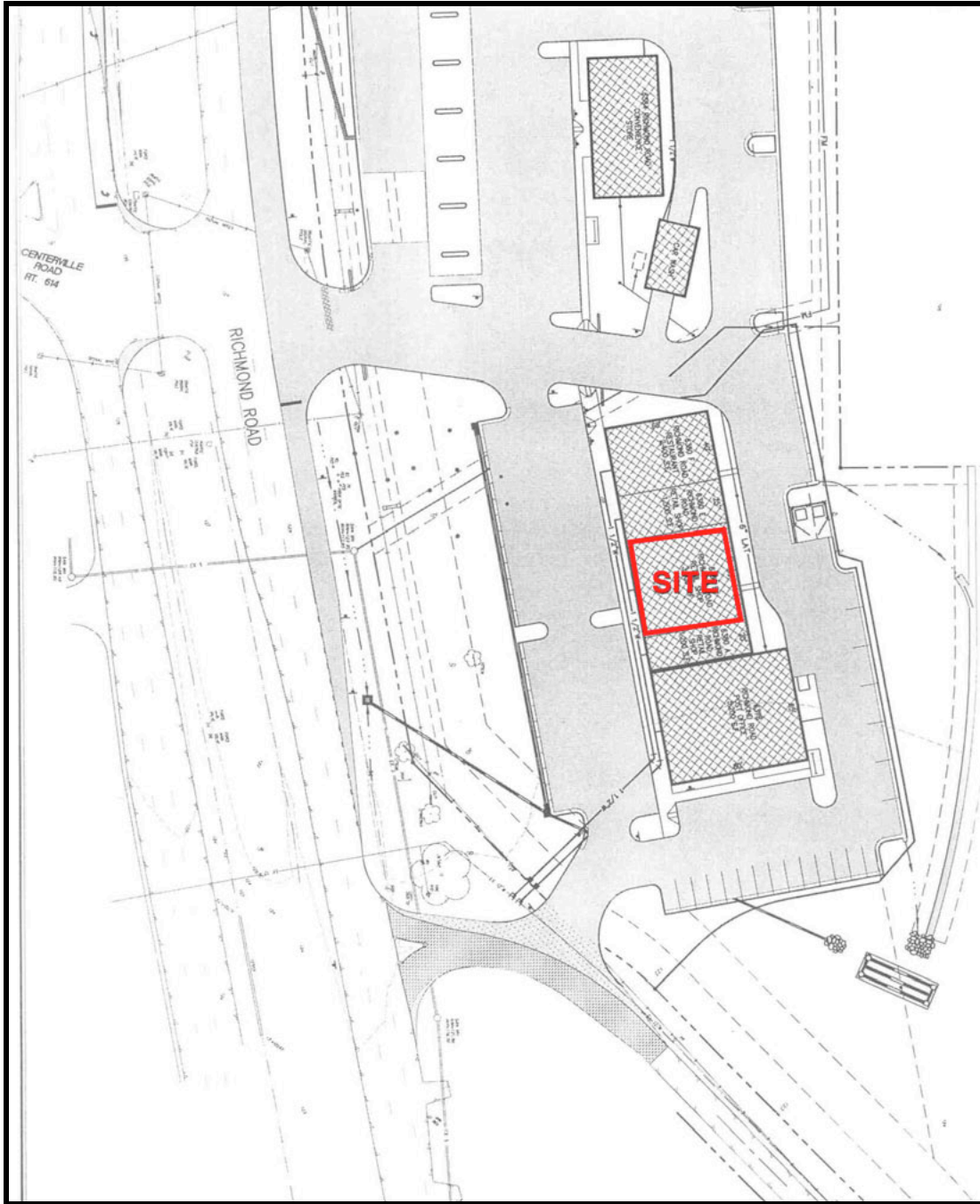

**LEASING PLAN**

**RJS & Associates. Inc.**

Commercial Real Estate  
Brokerage

423 N. Boundary Street, Ste 200  
Williamsburg, Virginia 23185-5629



**For more Information**

**Contact:**

Robert J. Singley, Jr. *CCIM*

**(757) 229-3139**

**Fax (757) 220-2475**

**rjsjr@rjsassoc.com**